

DEMOLITION KEYNOTES

- 1 REMOVE EXISTING ROOFING, COLUMNS, DOOR, LIGHTING, CONCRETE LANDING, GUTTERS, DOWNSPOUTS, ETC. RELATED TO THE EXISTING CANOPY
- 2 EXISTING COLUMNS TO REMAIN
- 3 REMOVE EXISTING METAL WALL PANELS ALONG EXISTING NORTH WALL
- 4 REMOVE EXISTING DOOR AND CLOSE OPENING WITH MATERIALS TO COORDINATE WITH NEW CONSTRUCTION ON BOTH SIDES
- 5 REMOVE EXISTING EXTERIOR WALL MOUNTED LIGHTS
- 6 REMOVE EXISTING WINDOW
- 7 REMOVE EXISTING WALL PANELS, STUDS & FINISHES FOR NEW WINDOW AND DOOR
- 8 CONSTRUCT TEMPORARY WALL FULL HEIGHT OF 400S125-18 STUDS AT 4' O.C. WITH 1/2" OSB LONG DIRECTION HORIZONTAL ON SOUTH FACE ONLY OVER 6 MIL VISQUEEN. PROVIDE R19 BATT INSULATION BETWEEN STUDS. PROVIDE BRIDGING AT 4' MAX ON CENTER. GUESE ON LAP SPICES IN VISQUEEN AS REQUIRED TO PROVIDE DUST BARRIER.

LEGEND

- 2 HOUR RATED METAL STUD WALL
- 2 HOUR RATED SHIRT WALL
- NON-RATED METAL STUD PARTITION WALL
- TEMPORARY WALL PER KEYNOTE 8
- B.L. BUILDING LINE, INSIDE FACE OF PANEL AND EDGE OF SLAB
- ACCESS FLOOR PER DETAIL XX
- ILLUMINATED EXIT SIGN PER ELECTRICAL

REV	DESCRIPTION	BY	DATE
A	100% SUBMITTAL	BP	11.30.11
REV	DESCRIPTION	DWN	CHK
		APP	DATE

LOS ANGELES  
DEPARTMENT OF WATER AND POWER  
HAYNES GENERATING STATION  
UNITS 11-16



**J. MILCZEWSKY  
and ASSOCIATES**

STRUCTURAL ENGINEERS:  
3275 E. DATE ST.  
BREDA, CA. 92823  
(714) 395-1289 BUS  
(714) 494-6012 FAX



**Scott Porter, Registered Professional Engineer**  
No. 5169  
Exp. 3-31-13  
Mechanical Engineering  
State of California

CONTROL BUILDING  
DEMOLITION & OVERALL FLOOR PLANS

DESIGNED	—	DRAWING NUMBER	A1.1
DRAWN	BAP		
CHECKED	JAM		
APPROVED	—		

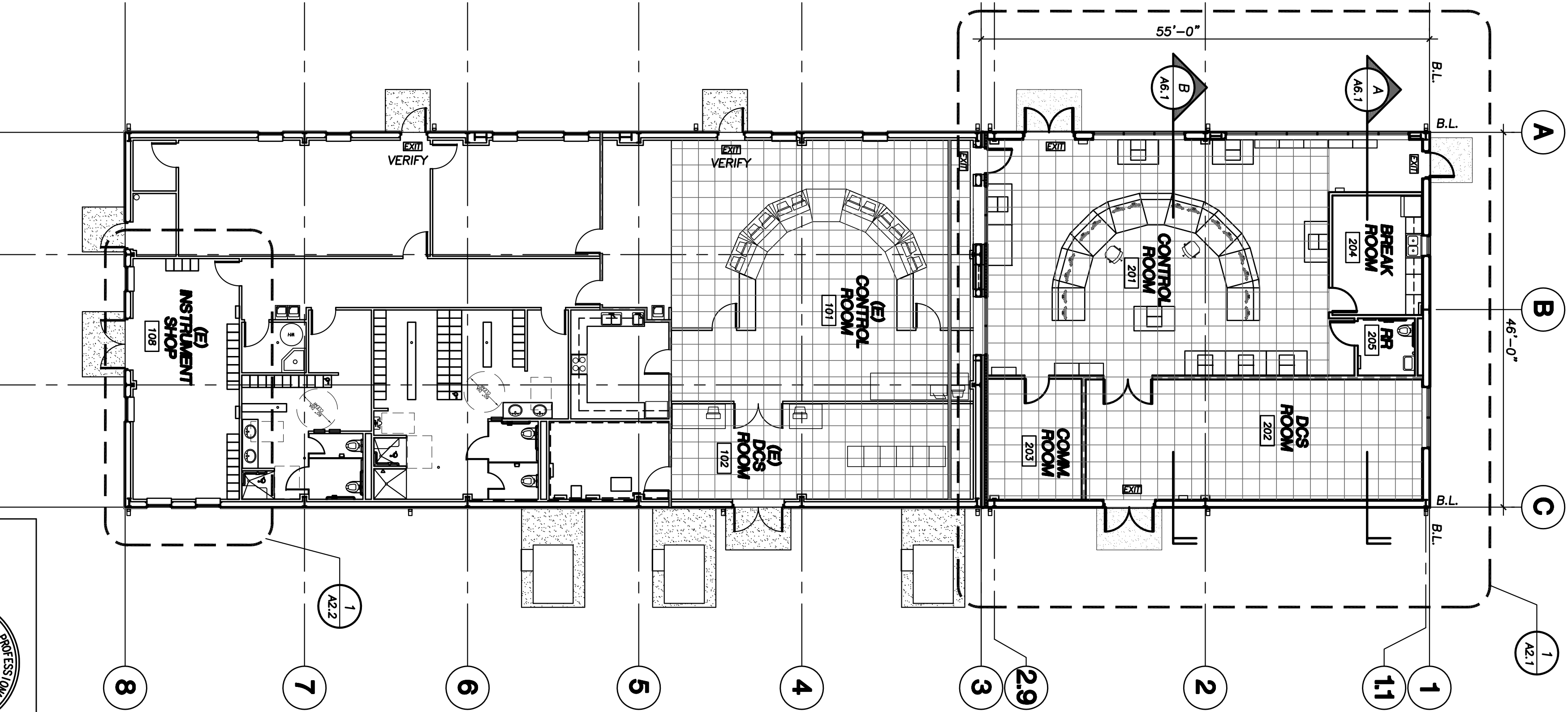

OVERALL FLOOR PLAN

SCALE: 3/32"=1'-0"

2

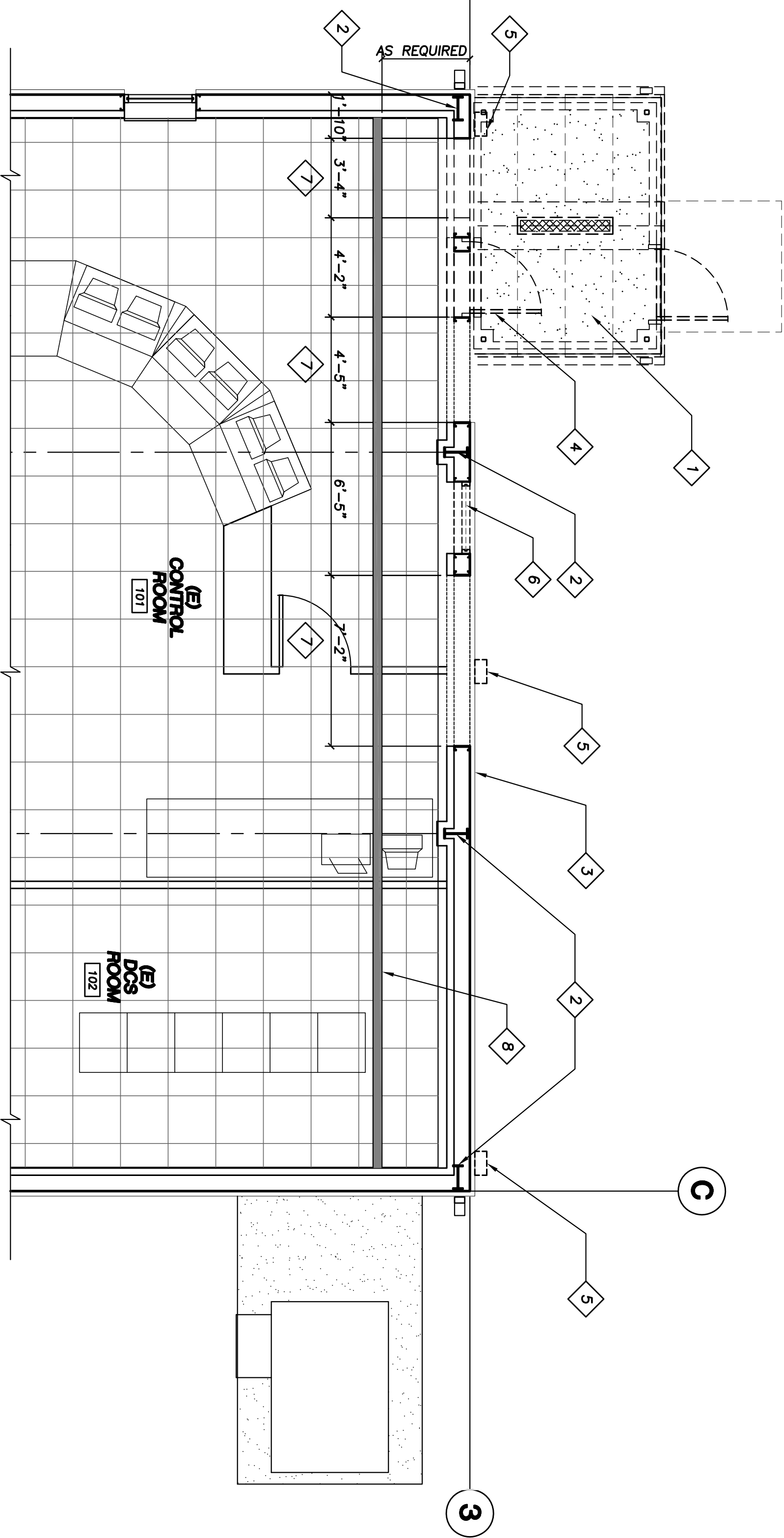

DEMOLITION PLAN

SCALE: 3/32"=1'-0"

2

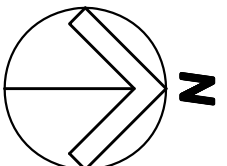

NOTE: REROUTE ALL EXISTING UTILITIES AFFECTED BY DEMOLITION